

ISTRUZIONI DI MONTAGGIO_impugnatura "DUE" su placca orizzontale

INSTALLATION ISTRUCTION_"DUE" handles on horizontal plate

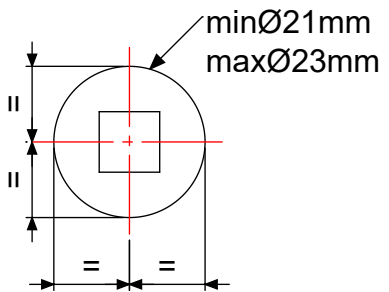

foro da eseguire nella porta rispettando la centratura con il quadro della serratura
hole to be drilled on the door respecting the centering with the square spindle

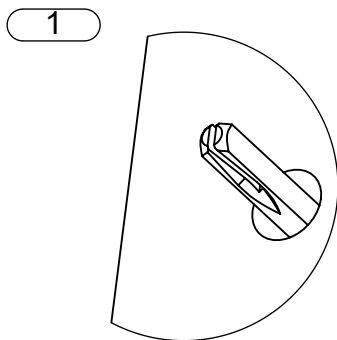

1
 inserire il ferro quadro mantenendo la scanalatura verso il basso
place the square spindle through the lock with the groove facing down

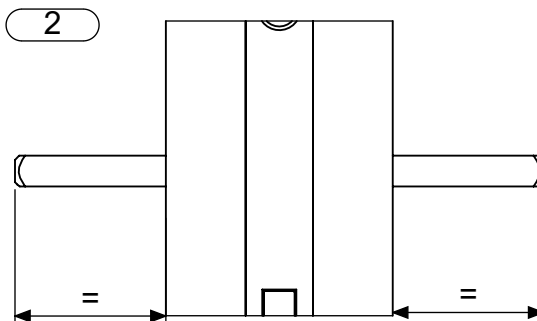

2
 fare attenzione a mantenere la stessa distanza del ferro quadro da entrambi i lati della porta
pay attention to keep the same projection of the square spindle on both sides of the door leaf

4

agganciare le placche di copertura alle sottoplacche
place the cover plate on top of the underplate

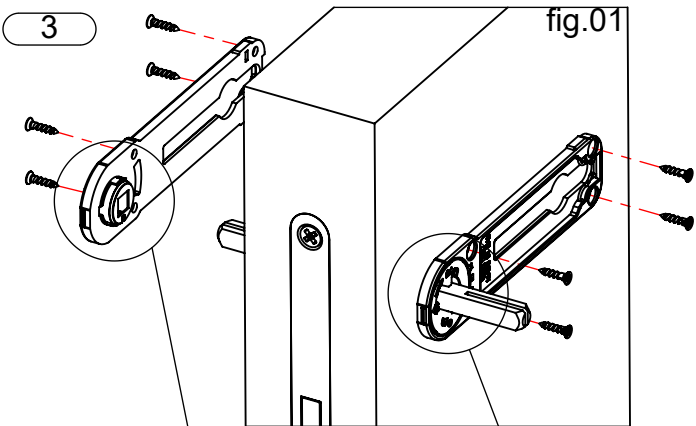
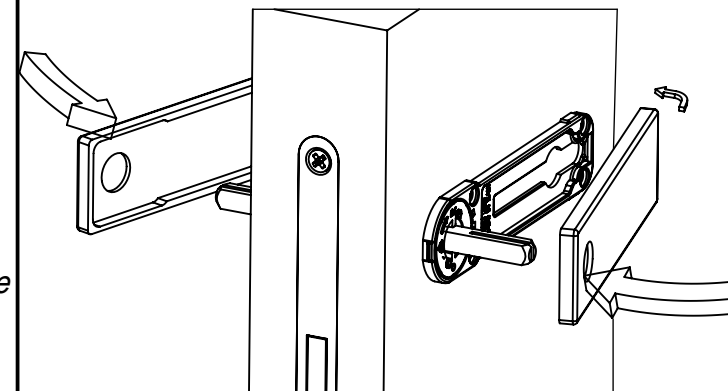
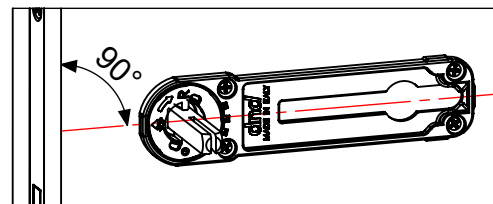

fig.01

3
 posizionare su entrambi i lati della porta la sottoplacca e fissarle con le viti (fig.01) rispettando l'allineamento dell'asse sottoplacca con il profilo della porta (fig.02)
apply on both side of the door the underplates paying attention to align them with the door's edge

fig.02



5

fig.03

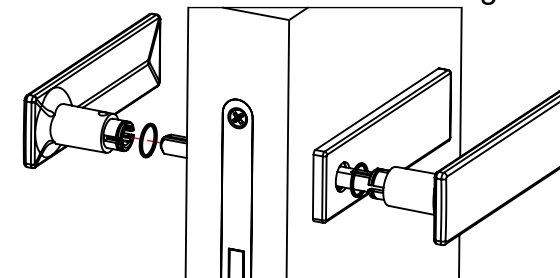

5
 applicare le impugnature dal ferro quadro (fig.03) e fissarle utilizzando le viti grano (fig.04)
slide both lever handles on the square spindle (fig.01) and fix them with the grub screw by keeping both of them firmly against the roses (fig.02)

fig.04

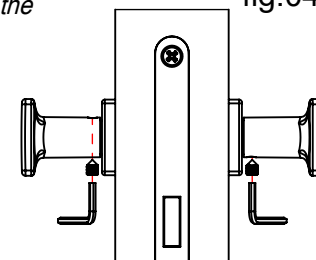

sottoplacca con molla di ritorno sinistra L per impugnatura SINISTRA
underplate with left spring L for the LEFT hand lever

sottoplacca con molla di ritorno sinistra R per impugnatura DESTRA
underplate with left spring R for the RIGHT hand lever

dnd

Dnd Martinelli S.r.l.
 Loc. Piani di Mura, 2
 25070 Casto (BS) Italia

t. +39 0365 899 113
 info@dndhandles.it
 www.dndhandles.it

I 1501.114 REV.00

ISTRUZIONI DI MONTAGGIO_impugnatura "DUE" su placca orizzontale INSTALLATION ISTRUCTION_"DUE" handles on horizontal plate

CON BOCCHETTE

WITH ESCUTCHEONS

fixare le sottobocchette in plastica alla porta con le viti e successivamente agganciare la bocchetta
apply the two plastic escutcheon with screw and then cover with metal escutcheons

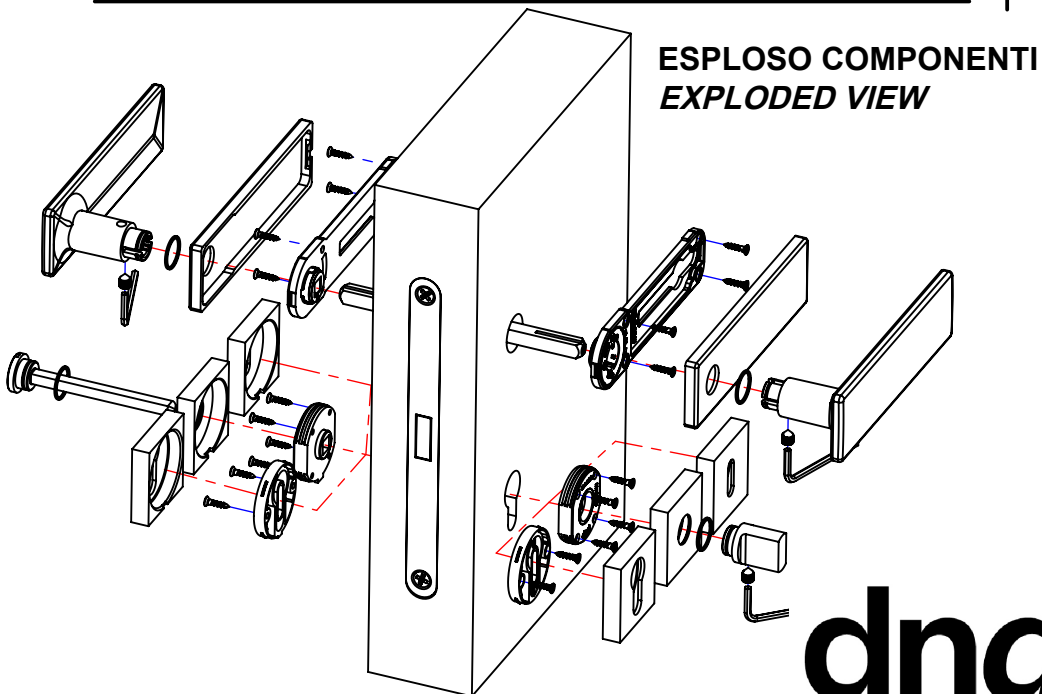
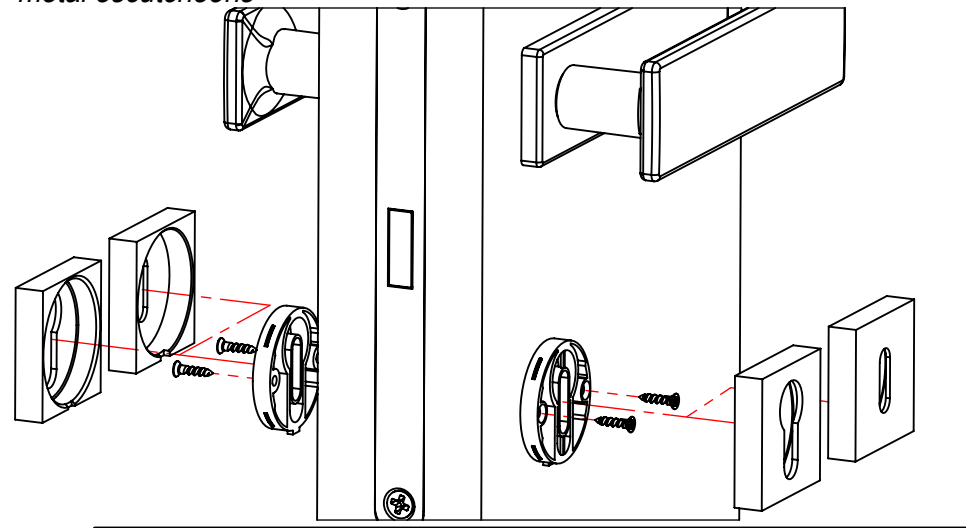

CON NOTTOLINO

WITH TURN & RELEASE

minØ19
maxØ21

foro da eseguire nella porta rispettando la centratura con il quadro della serratura
hole to be drilled on the door respecting the centering with the square spindle

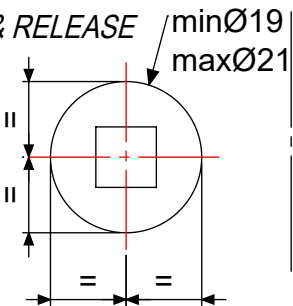

1

inserire il nottolino maschio nella serratura per centrare le bocchette con la serratura e successivamente bloccarle con le viti
insert the emergency release in the metal rose base and them through the lock to center it, and fix it with the screws

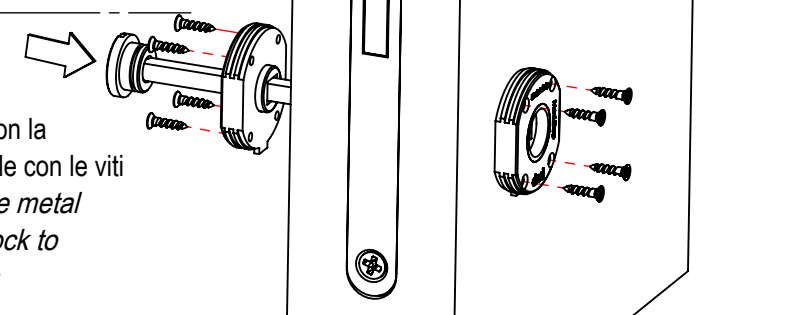

2

rimuovere il nottolino maschio e agganciare le bocchette alle sottobocchette
remove the emergency release and apply the metal escutcheons

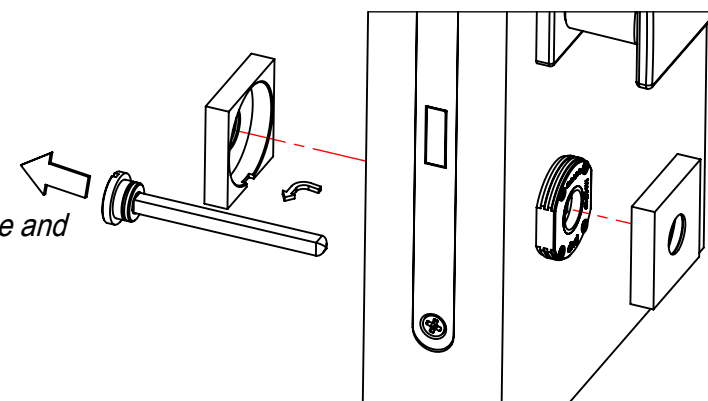

3

inserire il nottolino sulle bocchette e fissarlo con la vite grano
insert the emergency release and fix the snib with grub screw

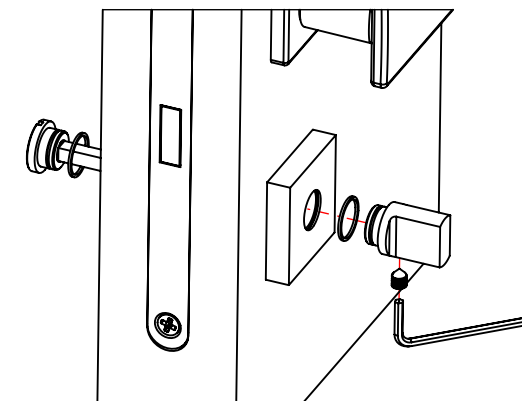

dnd