

# ISTRUZIONI DI MONTAGGIO\_pluris

## INSTALLATION INSTRUCTION\_pluris

1

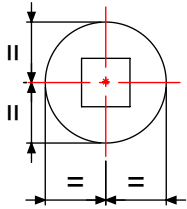

foro da eseguire nella porta rispettando la centratura con il quadro della serratura  
*hole to be drilled on the door respecting the centering with the latch square*

2

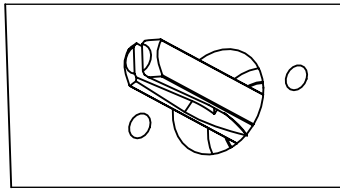

inserire il ferro quadro mantenendo la scanalatura verso il basso  
*place the square spindle through the lock with the groove facing down*

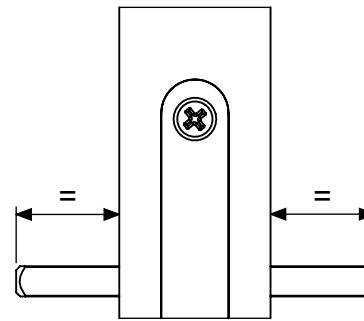

fare attenzione a mantenere la stessa distanza del ferro quadro da entrambi i lati della porta  
*pay attention to keep the same projection of the square spindle on both sides of the door leaf*

3

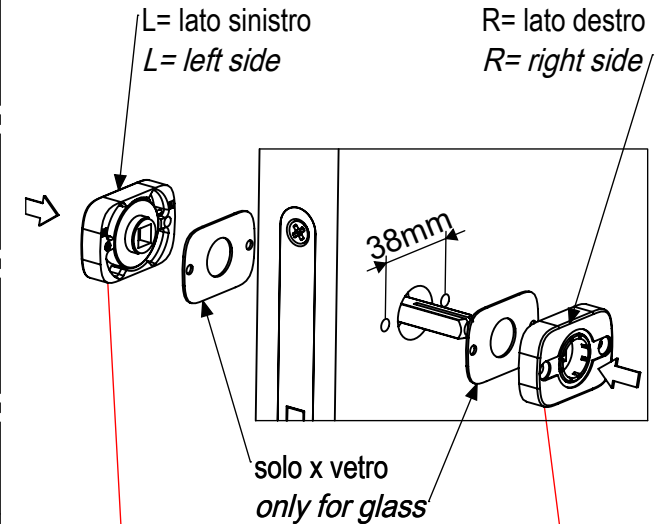

4

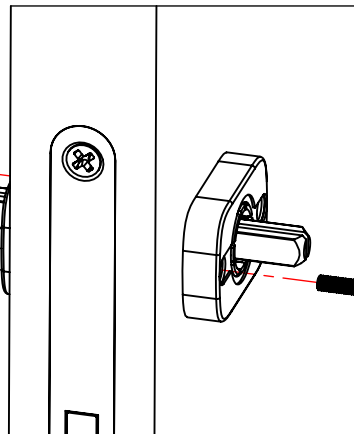

utilizzare le viti piu appropriate  
*use the appropriate screws*

5

applicare le impugnature sul ferro quadro e fissarle utilizzando le viti grano tenendole ben in appoggio sulle rosette  
*slide both lever handles on the square spindle and fix them with the grub screw by keeping both of them firmly against the roses*

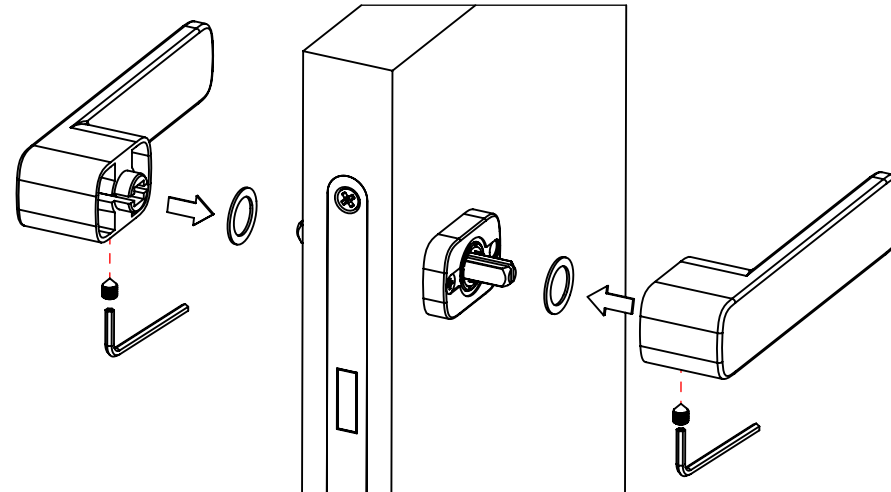

**dnd**

Dnd Martinelli S.r.l.  
 Loc. Piani di Mura, 2  
 25070 Casto (BS) Italia

t. +39 0365 899 113  
 info@dndhandles.it  
 www.dndhandles.it

# ISTRUZIONI DI MONTAGGIO\_pluris

## INSTALLATION INSTRUCTION\_pluris

### CON BOCCHETTE WITH ESCUTCHEONS

fissare le sottobocchette in plastica alla porta con le viti e successivamente agganciare la bocchetta  
*apply the two plastic escutcheon with screw and then cover with metal escutcheons*

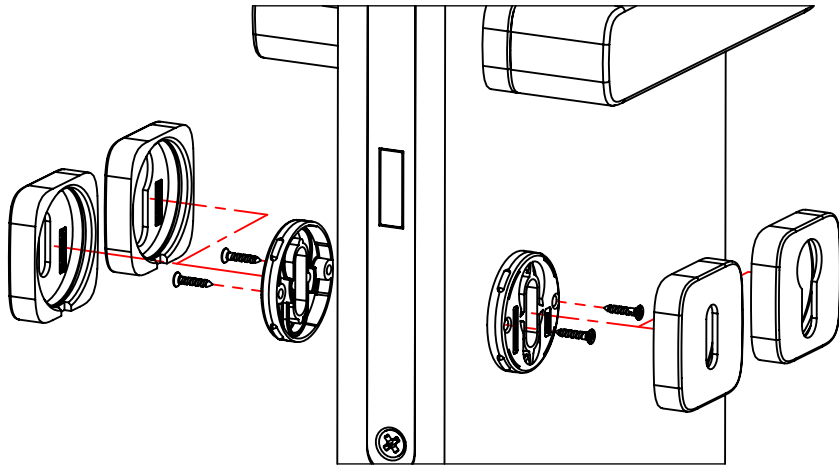

### ESPLOSO COMPONENTI EXPLODED VIEW

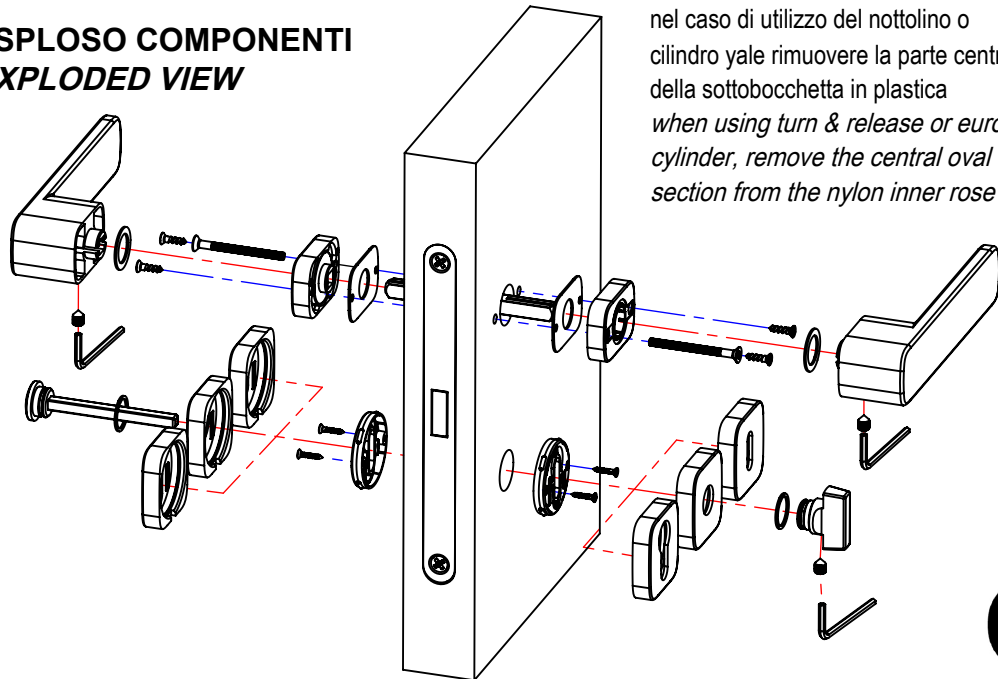

nel caso di utilizzo del nottolino o cilindro yale rimuovere la parte centrale della sottobocchetta in plastica  
*when using turn & release or euro cylinder, remove the central oval section from the nylon inner rose base*



foro da eseguire nella porta rispettando la centratura con il quadro della serratura  
*hole to be drilled on the door respecting the centering with the square spindle*

min Ø19mm  
max Ø21mm

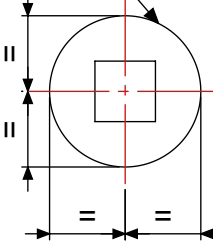

### CON NOTTOLINO WITH TURN & RELEASE

inserire il nottolino nella serratura per centrare le bocchette con la serratura e successivamente bloccarle con le viti  
*insert the emergency release in the metal rose base and them through the lock to center it, and fix it with the screws*

2

rimuovere il nottolino e agganciare le bocchette alle sottobocchette  
*remove the emergency release and apply the metal escutcheons*

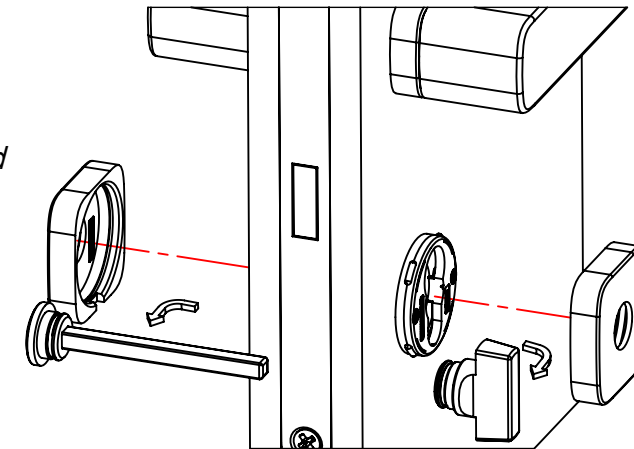
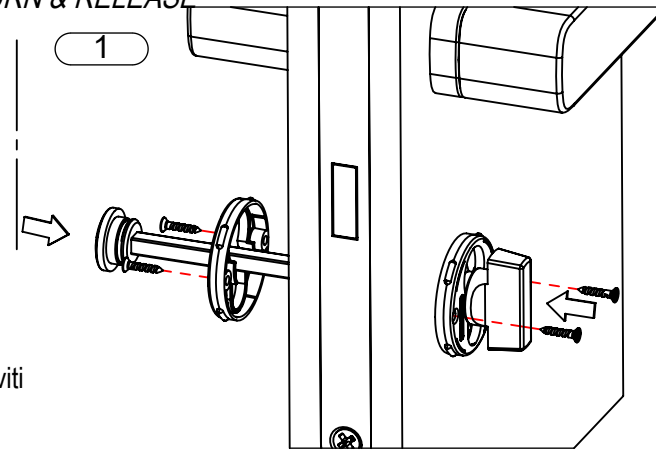

3

inserire il nottolino sulle bocchette e fissarlo con la vite grano  
*insert the emergency release and fix the snib with grub screw*

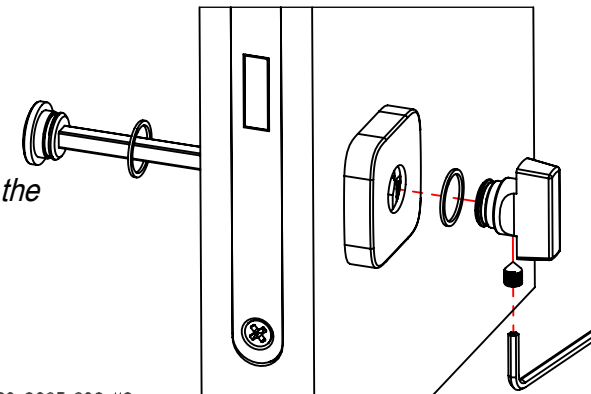

# dnd

Dnd Martinelli S.r.l.  
Loc. Piani di Mura, 2  
25070 Casto (BS) Italia

t. +39 0365 899 113  
info@dndhandles.it  
www.dndhandles.it